

CPS FlexOM Gateway

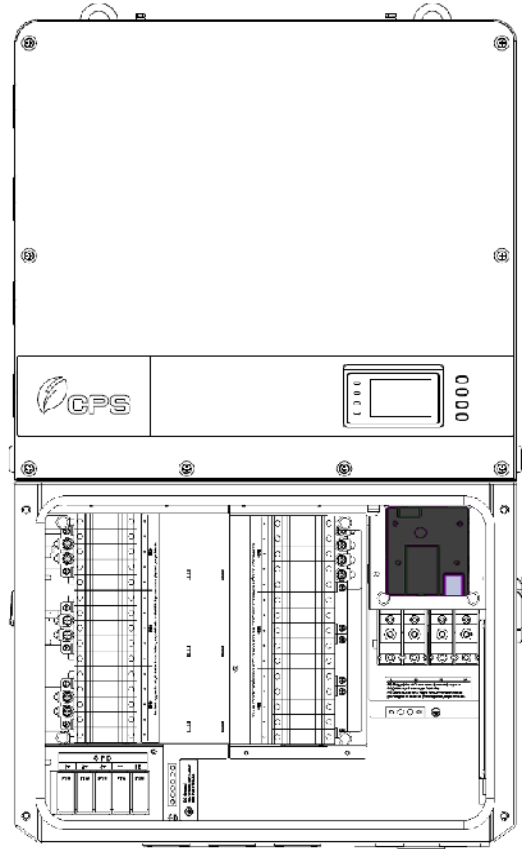
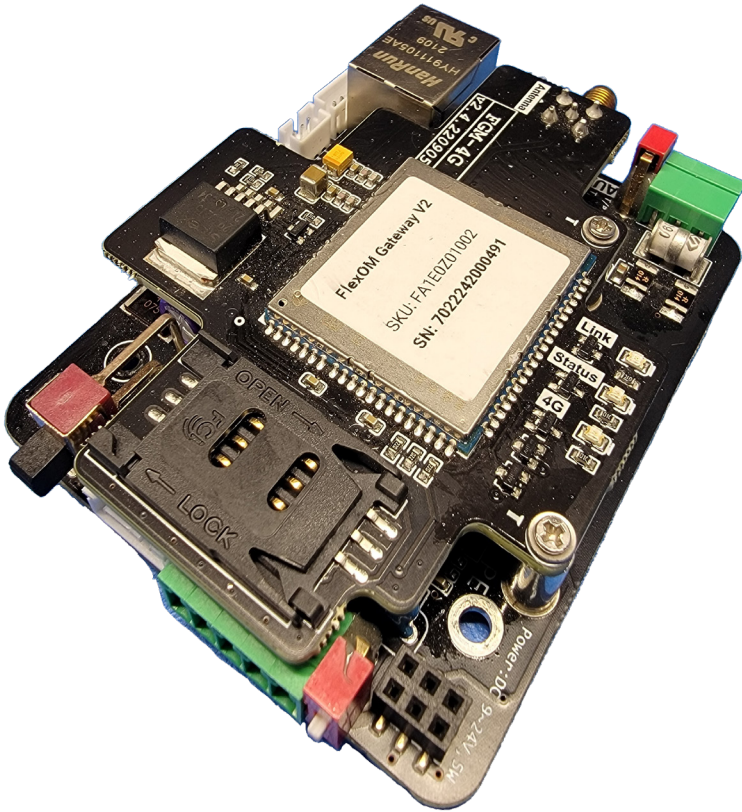

The CPS FlexOM Gateway is an advanced communications and controls solution for the CPS 25, 36, 50, 60, 100, 125, 275, and 350 kW inverters. The gateway is a Modbus client data logger and communications device. This flexible solution enables fast, efficient field service for CPS inverters via remote diagnostics and troubleshooting, setting adjustments, and firmware upgrades facilitated by the CPS Service team.

FlexOM Portal Bundles are offered by CPS with web portal data access to features such as data charting, monitoring alerts, remote resetting, kiosk view, and more!

Key Features

- Can be installed in a single inverter wire-box with no power or extra equipment required*
- Modbus communications input (up to 32 devices per card) - Modbus RS485
- Complete controls functionality via Modbus (per inverter or broadcast command)
- Flexible outbound communications
- Remote firmware update solution reduces the need for a truck roll
- Pass-through data via aux port for local third-party solutions (Modbus RTU via RS485)
- Includes WiFi or Bluetooth capability for use with "CPS Connect Pro" iOS or Android smart phone app
- Accessory enclosure allows for DIN rail mounting in third-party communication enclosures
- Distinguishable from the previous FlexOM card by its black printed circuit board

**Excluding legacy CPS 36 kW wire-boxes and 250/275 kW inverters*

Model Name	CPS FlexOM Gateway	CPS FlexOM Portal Bundle	CPS FlexOM-4G Portal Bundle
Hardware			
FlexOM Gateway card	X	X	X
DIN rail enclosure	X	X	X
Cellular antenna with 3 m cable, mounting bracket, and cable gland (for 4G pkgs only)			X
Misc. connectors and standoff screws	X	X	X
Pre-installed 4G SIM card			X
Software Performance Packages			
5 years of web portal access		X	X
Asset portfolio feature		X	X
Monitoring alerts		X	X
On/off reset remotely		X	X
Arc-fault clearing remotely		X	X
Active power setting remotely		X	X
Fault code observation		X	X
Public kiosk view		X	X
5 years of rolling data storage		X	X
"End user" account admin		X	X
Communications			
Inverter to gateway		RS485	
Internet access	Ethernet	Ethernet	4G cellular ¹
Inverter connections per gateway	32		
Protocol	SunSpec XML, DHCP, DNS Resolution, CPS Modbus RTU, TCP		
Setup and Programming			
Local Programming	CPS Connect Pro app (iOS and Android)		
Remote programming	CPS Service		
Datalogging Specifications			
Data sampling rate	Programmable data sampling (1- to 20-minute sample rate)		
Local data storage	30 days based on 20-minute intervals ²		
Data parameters	Modbus ID, Inverter S/Ns, Model, TYield/DYield(kWh), RunT(min), Mode, Upv(V), Ipv(A), Pac(kW), PF, Freq(Hz), Uabc(V), Iabc(A)		
Power Supply			
DC input voltage	9-24 V _{DC} max. (provided when installed in inverter wire box)		
Power consumption	< 6 W		
Environmental Parameters			
Ambient temperature range	-22°F to 185°F / -30°C to 85°C, natural convection cooling		
Environmental protection	Installed in NEMA 4X inverter wire box or external enclosure (CPS Legacy 36 kW and 250/275 kW inverters require gateway installation in a separate NEMA4 enclosure - not included)		
Relative humidity	< 85% non-condensing		
Mechanical Parameters (per unit)			
FlexOM gateway card dimensions (H × W × D)	3.97 × 2.71 × 0.83 in (101 × 69 × 21 mm)		
FlexOM gateway enclosure dimensions (H × W × D)	4.1 × 3.0 × 1.3 in (103 × 77 × 32 mm)		

1) 4G cellular network coverage in US and Canada locations.

2) FlexOM Gateway only stores data when the Gateway card is continuously powered.

